

# FLEXIPOLE PLUS UPM MOUNT

## DIRECT MOUNTING STANDS FOR INGENICO LANE DEVICES

Expertly designed for Ingenico Lane devices, the FlexiPole Plus Direct/UPM Mount securely and directly mounts your chosen Ingenico Lane device.

- Unique Ingenico UPM Interface on FlexiPole Plus Stand
- Expertly designed to directly mount Ingenico Lane devices (also compatible with Desk 1500)
- 140° tilt, 330° swivel for optimum user experience
- Wide base to accommodate large cable connectors
- Quick, easy installation
- Protects and secures device
- Sleek design compliments new payment devices
- Excellent cable management
- Adhesive or screw mounted
- Quick Release option for easy device removal
- Security Screw and/or Tether options for added security



Part Number	ASS4U121
Tilt/Swivel	140° /330°

## TECHNICAL SPECIFICATIONS

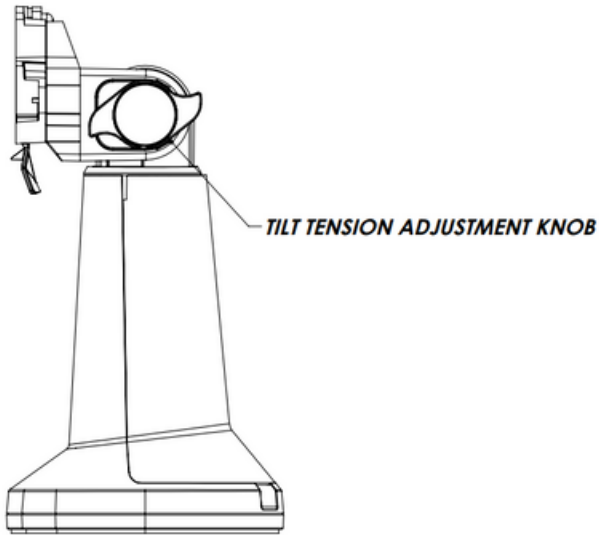

**RIGHT SIDE VIEW**

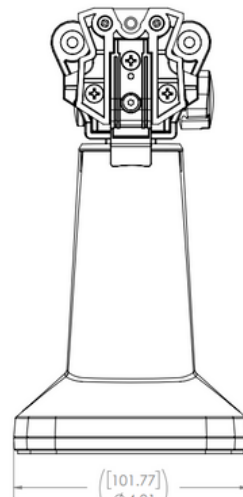

**FRONT VIEW**

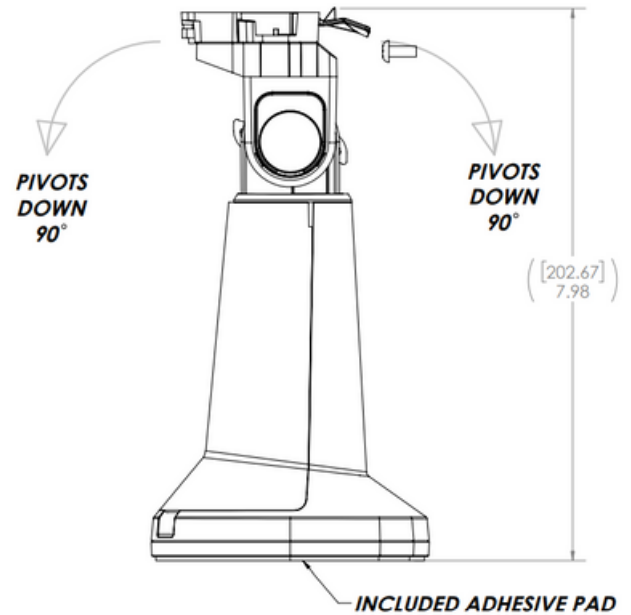

**LEFT SIDE VIEW**

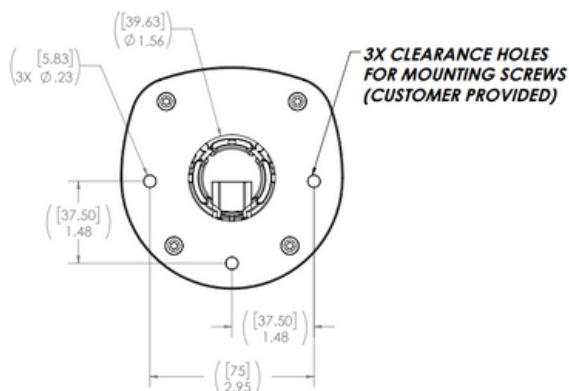
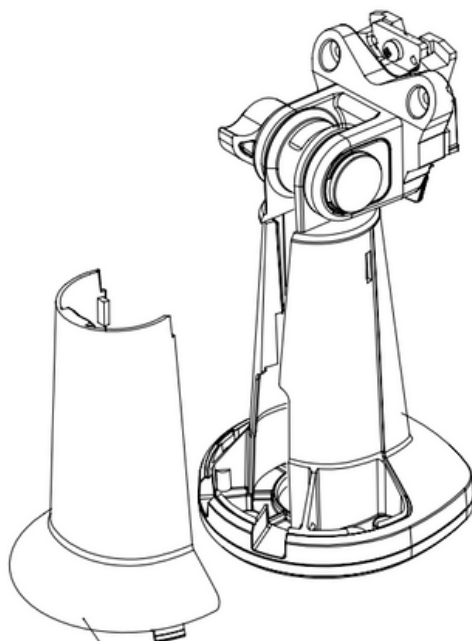

**BOTTOM VIEW**

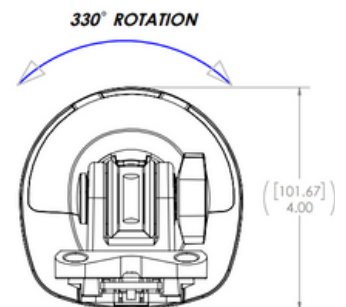

**TOP VIEW**